



MUB (A)

The MUB (A) fans have impellers with backward curved blades, manufactured from aluminium. The MUB 355-450 is equipped with external rotor motors. MUB 500-630 are driven by an IEC standard motor.

The casing consists of a corrosion-resistant aluminum frame with fiberglass reinforced plastic / aluminium corners of PA6; highly shock resistant. The double skin panels are manufactured from galvanized steel with 20 mm mineral wool insulation.

To avoid condensation the profile is provided with a separate chamber to fix screws. The Multi-box fans are delivered for straight through airflow but can easily be rebuilt due to removable panels. This allows flexible ventilation solutions. The MUB (A) can also be used as extract- or supply air unit in air handling units. Installation in any mounting position is possible.

Performance Data & Curves

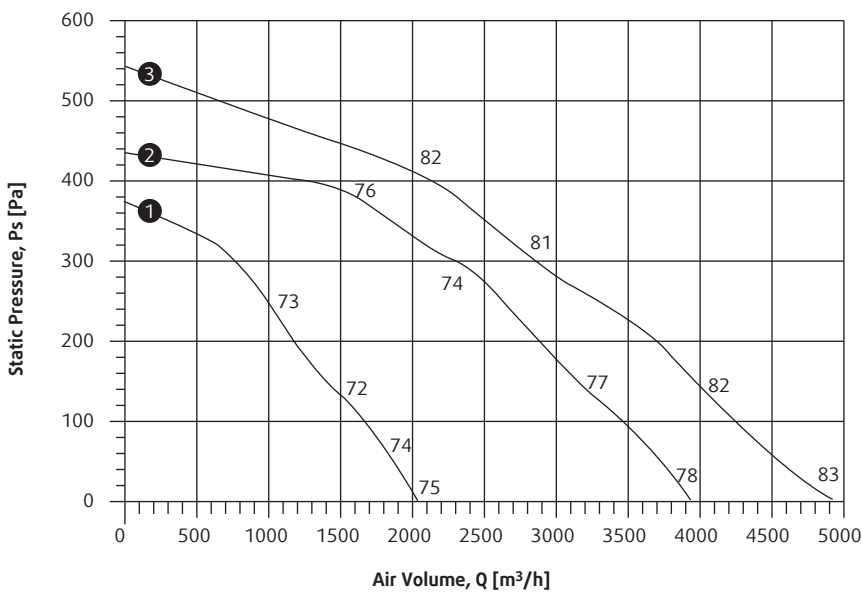

- 1 MUB (A) 025 355E4-A2 — 1383rpm
- 2 MUB (A) 042 400E4-A2 — 1385rpm
- 3 MUB (A) 042 450E4-A2 — 1335rpm

		MUB (A) 025 355E4-A2	MUB (A) 042 400E4-A2	MUB (A) 042 450E4-A2
Voltage	V	230	230	230
Frequency	Hz	50	50	50
Phase	~	1	1	1
Max. Motor Input Watts	W	225	483	781
Max. Current	A	0.94	2.08	3.43
Nominal Speed	RPM	1383	1385	1335
Max. Airflow	m3/h	2034	3935	4936
Sound Pressure level at 3m	dB(A)	55	49	52
Max. Temperature	°C	40	40	40
Motor Insulation Class		F	F	F
Motor Protection	IP	44	44	44
Capacitor	µF	6	14	14
Weight	kg	37	58	60

Model	63	125	250	2k	500	1k	4k	8k	Overall
025 355E4-A2	49	51	55	57	56	53	48	41	62
042 400E4-A2	43	45	49	51	50	47	42	53	56
042 450E4-A2	46	48	52	54	53	50	45	38	59

Performance Data & Curves



- 1 MUB (A) 042 500D4-A2 — 1435rpm
- 2 MUB (A) 062 560D4-A2 — 1456rpm
- 3 MUB (A) 062 630D4-A2 — 1471rpm

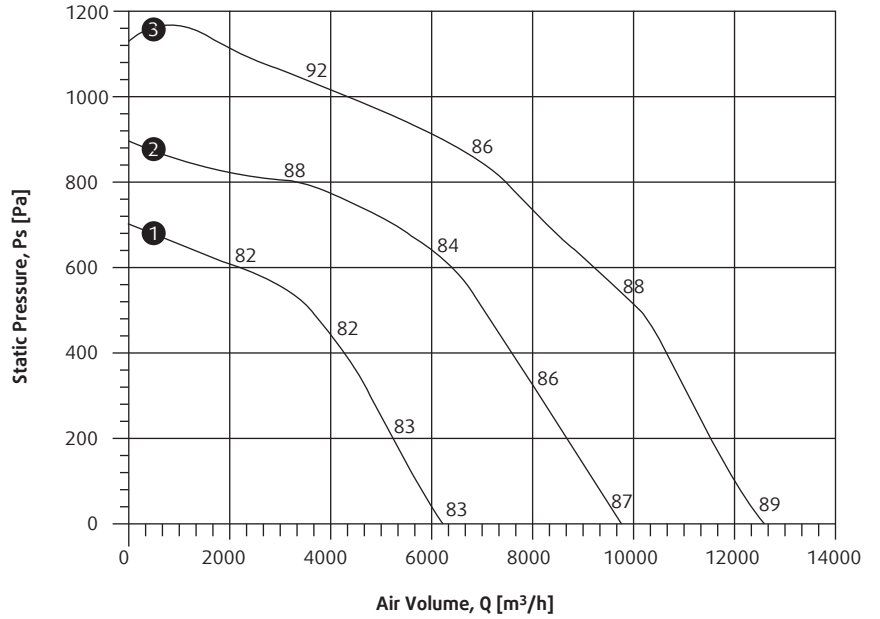

		MUB (A) 042 500D4-A2	MUB (A) 062 560D4-A2	MUB (A) 062 630D4-A2
Voltage	V	415	415	415
Frequency	Hz	50	50	50
Phase	~	3	3	3
Max. Motor Input Watts	W	1500	3000	4000
Max. Current	A	3.20	4.50	7.90
Nominal Speed	RPM	1435	1456	1471
Max. Airflow	m3/h	6152	9702	12643
Sound Pressure level at 3m	dB(A)	56	57	69
Max. Temperature	°C	40	40	40
Motor Insulation Class		F	F	F
Motor Protection	IP	55	55	55
Weight	kg	70	130	135

Model	63	125	250	2k	500	1k	4k	8k	Overall
042 500D4-A2	50	52	56	58	57	54	49	42	63
062 560D4-A2	51	53	57	59	58	55	50	43	64
062 630D4-A2	63	65	69	71	70	67	62	55	76

DIMENSIONS

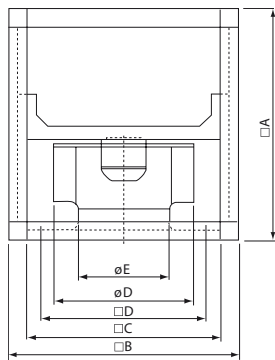

	A	B	C	D	D	E
MUB (A) 025 355	500	500	420	378	355	224
MUB (A) 042 400	670	670	590	548	404	253
MUB (A) 042 450	670	670	590	548	454	286

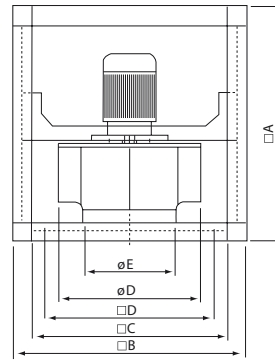

	A	B	C	D	D	E
MUB(A) 042 500	670	670	590	548	504	321
MUB(A) 062 560	800	800	720	676	570	361
MUB(A) 062 630	800	800	720	678	635	407



MUB (A) /T

- Motor outside of the air stream
- Low sound level
- Maintenance-free and reliable

All MUB(A)/T fans have impellers with backward curved blades, manufactured from Galvanised Iron, and IEC standard motors for all 400V three phase motors. Motors are outside the air stream. The casing consists of an aluminium frame with fiberglass reinforced plastic / aluminium corners and double skin, galvanised steel panels with a 20 mm mineral wool insulation. Panels are removable, allowing flexible ventilation solutions. The MUB(A)/T bottom panel is shaped as a grease tray and incorporates a premounted drain plug. Standard execution, seen in airflow direction: service door left, top outlet.

Performance Data & Curves

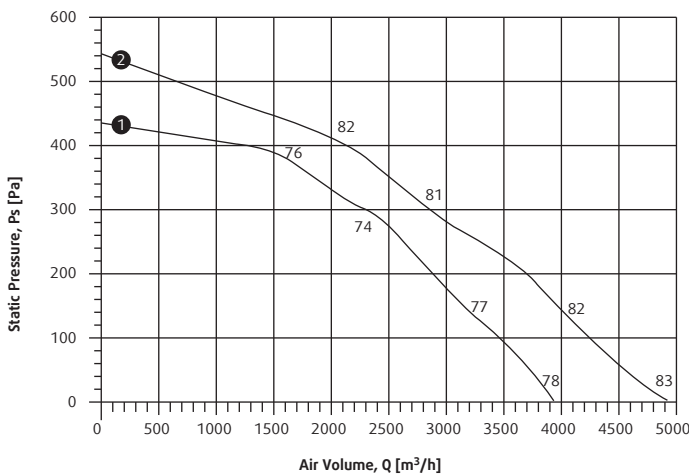

- 1 MUB(A)/T 042 400D4 — 1385rpm
- 2 MUB(A)/T 042 450D4 — 1335rpm

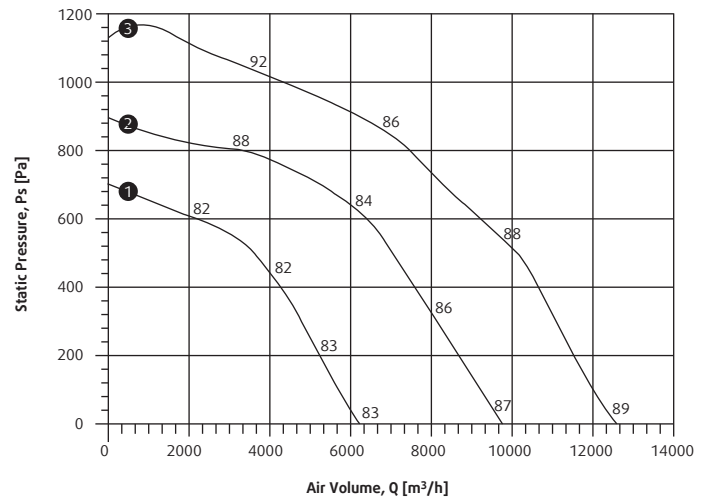

- 1 MUB(A)/T 042 500D4 — 1435rpm
- 2 MUB(A)/T 062 560D4 — 1456rpm
- 3 MUB(A)/T 062 630D4 — 1471rpm

MUB(A)/T		042 400D4	042 450D4	042 500D4	062 560D4	062 630D4
Voltage/Frequency	V/50 Hz	400	400	400	400	400
Phase	~	3	3	3	3	3
Power at shaft	W	370	550	1500	3000	4000
Current	A	1.05	1.4	3.2	4.5	7.9
Max air flow	m3/h	3935	4936	6152	9702	12643
R.p.m.	min ⁻¹	1385	1335	1435	1456	1471
Max temp. of transported air	°C	100	100	100	100	100
Sound pressure level at 3 m	dB(A)	49	52	56	57	69
Weight	kg	61.6	64	73	135	137
Insulation class, motor		F	F	F	F	F
Enclosure class, motor		IP 55	IP 55	IP 55	IP 55	IP 55

Model	63	125	250	2k	500	1k	4k	8k	Overall
042 400D4	43	45	49	51	50	47	42	53	56
042 450D4	46	48	52	54	53	50	45	38	59
042 500D4	50	52	56	58	57	54	49	42	63
062 560D4	51	53	57	59	58	55	50	43	64
062 630D4	63	65	69	71	70	67	62	55	76



- Temperature of transported air up to 100°C
- Multifunctional use for example for kitchen exhaust
- Easy to maintain
- Airflow direction can be modified on site
- Sizes from 355 to 630
- Air flow up to 12634 m³/h



Drain

Grease and condensate tray, insulated double skin panel with 1" drain plug as standard.

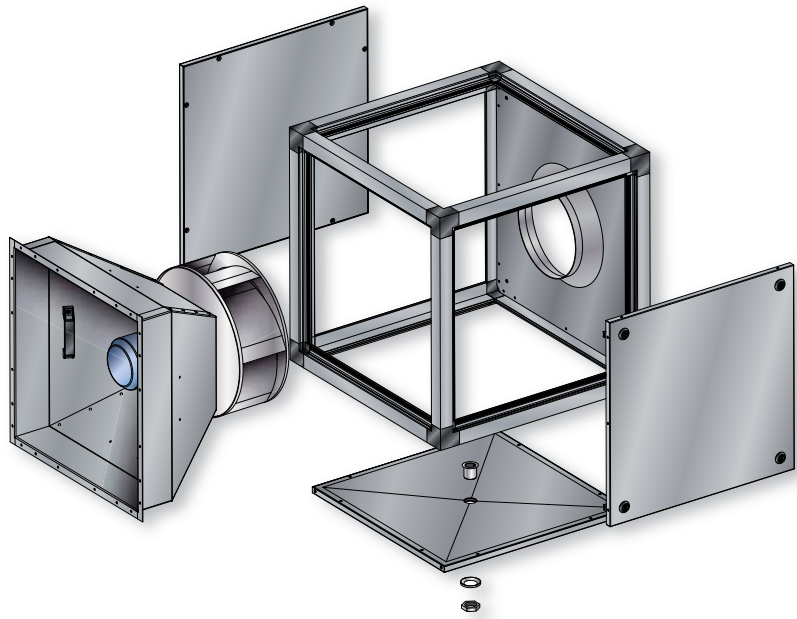

DIMENSIONS

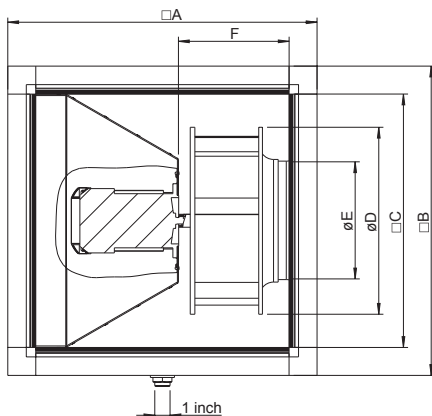

MUB (A)/T	□A	□B	□C	∅D	∅E	F
MUB 042 400	670	670	548	404	253	300
MUB 042 450	670	670	548	454	286	300
MUB 042 500	670	670	548	504	321	300
MUB 062 560	800	800	718	570	361	321
MUB 062 630	800	800	718	635	407	321