

## Bifurcated axial fans AXCBF

### Standard features

- Aerofoil impeller with adjustable pitch angle.
- Hub and blades manufactured from high strength aluminium cast alloy.
- Bifurcated casing, hot dip galvanised steel to EN ISO1461.
- Flanges to Eurovent 1/2.
- Three phase motors, IP55, insulation class F, in accordance with EN60034-5 IEC85, terminal box mounted directly onto the motor.
- Suitable for operating temperatures up to 200°C in continuous operation.
- Maximum ambient temperature of 55°C.



The Systemair AXCBF range of bifurcated medium pressure axial fan has been developed for applications with an atmosphere which would either require special motors or reduce the lifetime of a standard motor. The motors of AXCBF are out of the airstream. Available in sizes from 315 up to 1250mm nominal diameter.

### Casing

The casing manufactured from mild steel hot dip galvanized in accordance with DIN EN ISO 1461. Easy access to the terminal box. The motor is completely separated from the airstream.

### Motors

The IEC standard three-phase motors correspond to the current efficiency classification. IP 55 degree of protection, insulation class F according to EN60034-5

Speed control of the standard motor is possible using a frequency inverter. Terminal box on the motor.

The transported air temperature of up to 200deg C in continuous operation.

You can find more information in our online catalogue on [www.systemair.com](http://www.systemair.com)

### Impeller Geometry

Aerodynamic axial impeller manufactured from cast aluminium alloy for maximum efficiency.

### Quality

Systemair is certified according to ISO9001:2015. The Systemair quality system is regularly monitored by TUV Sud.



### Ordering code

AXCBF POD 630 D 4 - 26°

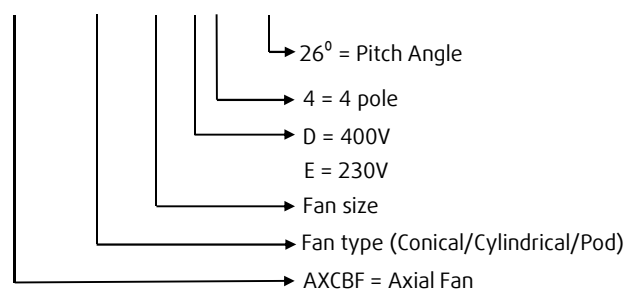

## DIMENSIONS

### CONICAL BIFURCATED FAN

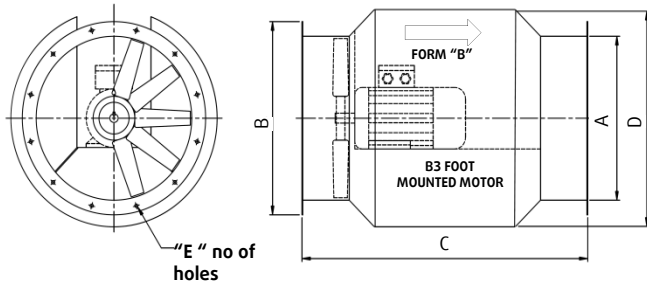

### CYLINDRICAL BIFURCATED FAN

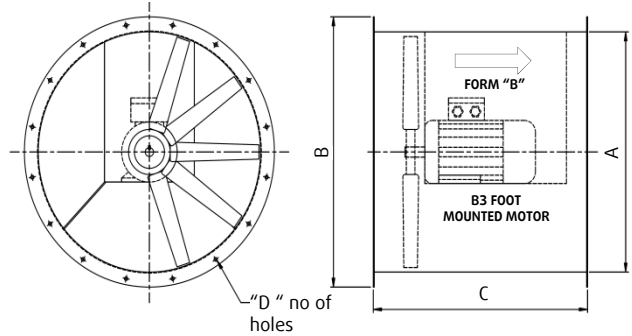

In metric

Dia.	Motor Frame (B3)	A	B	C	D	E
315	71-80	315	395	530	500	Ø10, 8 holes, 355 P.C.D.
355	71-80	355	435	530	500	Ø10, 8 holes, 395 P.C.D.
400	71-90	400	480	625	595	Ø12, 8 holes, 450 P.C.D.
450	71-100	450	600	660	695	Ø12, 8 holes, 500 P.C.D.
500	71-100	500	600	660	695	Ø12, 12 holes, 560 P.C.D.
560	71-132	560	660	700	750	Ø12, 12 holes, 620 P.C.D.

In metric

Dia.	Motor Frame (B3)	A	B	C	D
	71-80			480	
630	90-100	630	730	600	Ø12, 12 holes, 690 P.C.D.
	112-132			750	
	71-80			480	
710	90-100	710	810	600	Ø12, 16 holes, 770 P.C.D.
	112-132			750	
	71-80			480	
800	90-100	800	900	600	Ø12, 16 holes, 860 P.C.D.
	112-132			750	
	71-80			480	
900	90-100	900	1005	600	Ø15, 16 holes, 970 P.C.D.
	112-132			750	
	71-80			480	
	90-100			600	
1000	112-132	1000	1105	750	Ø15, 16 holes, 1070 P.C.D.
	160-180			1000	
	200-225			1100	
	112-132			750	
1250	160-180	1250	1390	1000	Ø15, 20 holes, 1320 P.C.D.
	200-225			1100	

### POD BIFURCATED FAN

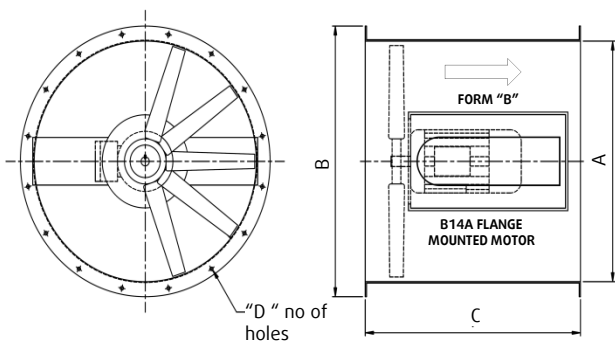

In metric

Dia.	Motor Frame (B14A)	A	B	C	D
630	132 only	630	730	750	Ø12, 12 holes, 690 P.C.D.
710	132 only	710	810	750	Ø16, 12 holes, 770 P.C.D.
800	132 only	800	900	750	Ø12, 16 holes, 860 P.C.D.
900	132	900	1005	750	Ø15, 16 holes, 970 P.C.D.
	160			1000	
	132			750	
1000	160-180	1000	1105	1000	Ø15, 16 holes, 1070 P.C.D.
	200-225			1100	
	132			750	
1250	160-180	1250	1390	1000	Ø15, 20 holes, 1320 P.C.D.
	200-225			1100	